

Standard 1.5X Magnification, InfiniTube

See More by [Infinity Photo-Optical Company](#)



Standard (with no In-Line Attachment), InfiniTube, #56-125



Stock **#65-608** [CONTACT US](#)

- 1 +

£952⁰⁰

ADD TO CART

Volume Pricing	
Qty 1+	£952.00 each
Need More?	Request Quote

⚠ Prices shown are exclusive of VAT/local taxes

Product Downloads

SPECIFICATIONS

General

InfiniTube™ Standard 1.5X

Model Number:

Fixed Magnification Lens	Type:
Optical Properties	
Objective Required	Primary Magnification PMAG:
Threading & Mounting	
C-Mbunt	Mount:
Regulatory Compliance	
Compliant	RoHS 2015:
Compliant	Reach 224:
View	Certificate of Conformance:

PRODUCT DETAILS

• Direct to Video C-Mount for 2/3" and Smaller Sensor Cameras ([InfiniTube™ FM Series](#) for 1/2")

• [Mitutoyo](#) and [Achrovid™](#) Objectives Sold Separately

• Internal Focusing

• See Description Tab for Required Components

This in-line assembly unit is used to mount [Mitutoyo](#) or [Achrovid™](#) long working-distance objectives to C-mount cameras, yielding magnifications not possible with ordinary video lenses, such as 50X magnification. The InfiniTube™ system can be configured in a variety of fashions. It can be utilized alone (InfiniTube™ Standard [#56-125](#)) for applications where illumination is provided from another source such as a backlight or directional illumination.

The first in-line attachment ([#56-126](#)) has been designed for high performance with objectives having a magnification of 10X or below and is not suggested for use with higher magnification objectives. The second in-line unit ([#56-191](#)) has been designed to work with increased efficiency when used with magnifications of 10X or higher, but can be utilized with all magnifications. An InfiniTube™ In-line Assembly ([#54-590](#)) is also offered, comprised of the InfiniTube™ Standard and the higher magnification in-line attachment. This Assembly can be used with all magnifications. A filter holder, which attaches to the InfiniTube™ itself, can be added to the systems to introduce 25mm diameter filters. These lenses are commonly used in microscopy and wafer inspection.

By utilizing an in-path beamsplitter and side-port illumination tube with collimating optics, the In-Line Assembly ([#54-590](#)) provides incident illumination parallel to the optical axis (coaxial). Coaxial illumination requires an optional [Fiber Optic Illuminator](#) and a 1/4" diameter [Fiber Optic Light Guide](#).

A version of the InfiniTube™ is specifically designed only for Zeiss ICS-corrected objectives ([#58-538](#), 160mm tube lens design). Shorter than the Standard model, this model has color-compatible correction for use exclusively with Zeiss ICS objectives. The RMS adapter ([#53-786](#)) is required to connect [#58-538](#) to the Zeiss EC Plan-Neofluar® objectives.

The RMS adapter ([#53-786](#)) is required to connect [#58-538](#) to the Zeiss ICS objectives. Since even the slightest vibration will affect such small fields-of-view seen with the InfiniTube™ we recommend [vibration isolation equipment](#) when using objectives greater than 10X in magnification. We also recommend the use of a focusing mechanism (such as the Rack and Pinion Movement mount [#54-794](#)) when using the lens alone.

Mounting clamp ([#57-788](#)) is included with [#54-590](#), [#56-125](#) and [#58-538](#). Note that an objective, objective adapter, light guide, and illuminator are not included.

TECHNICAL INFORMATION

InfiniTube™ Filter Holder

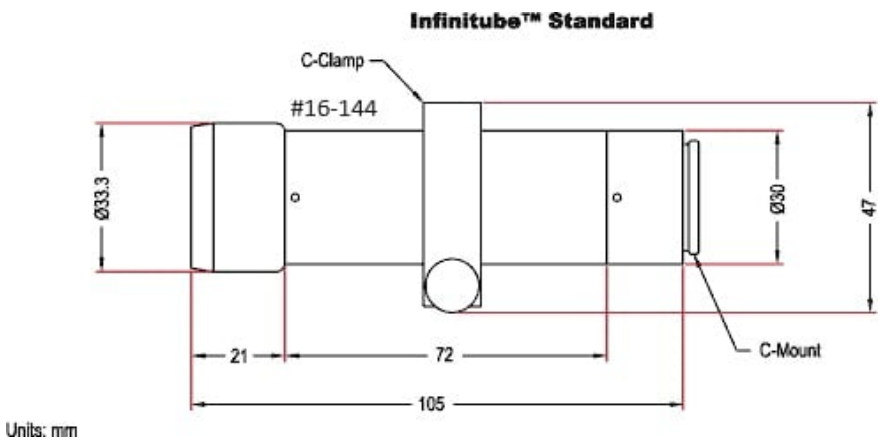
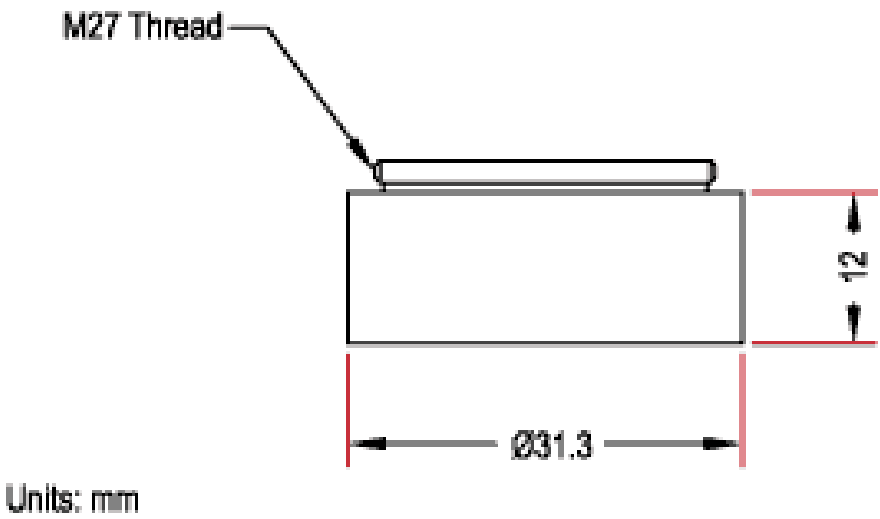

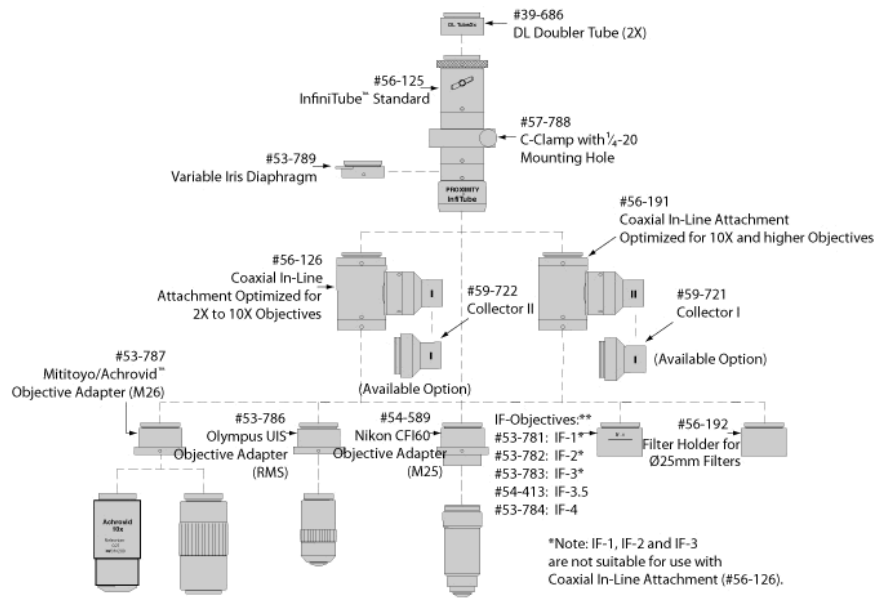

InfiniTube™ In-Line Attachment

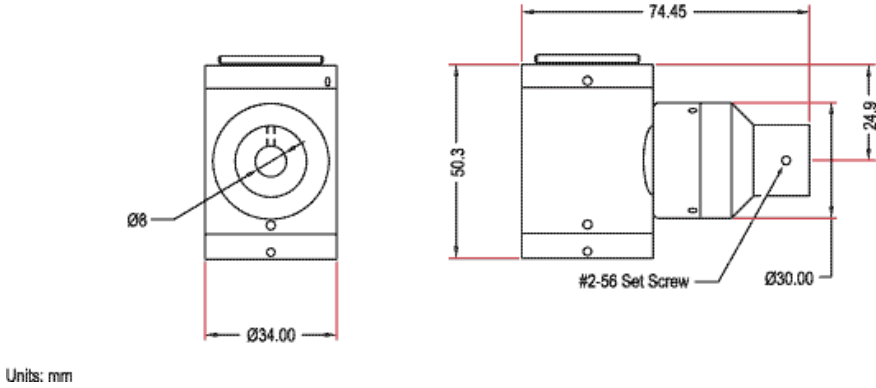

#54-562		
Item		Stock No.
InfiniTube In-Line Assembly Unit		#54-590
Hitachi KP-D20B Camera		#55-837
15.1" LCD Monitor (US Version Only)		#56-522
Y-C Cable (6 ft.)		#39-255
Mitutoyo/Achrovid™ Objective Adapter		#53-787
M-150 Fiber Optic Illuminator		#55-718
Fiber Optic Light Guide (48" L)		#39-367
Fiber Optic Adapter		#38-944
Standard Boom Stand		#54-120
Rack & Pinion Mounting Plate		#54-123