

[All Products](#) / [Cameras](#) / [LUCID Vision Labs Cameras](#)

# LUCID Vision Labs™ SENS AiZ Intelligent Vision CMOS Camera

See More by [LUCID Vision Labs™](#)



- 12.33 Megapixel Sony IMX500 Intelligent Vision CMOS Sensor
- Power Over Ethernet (PoE) for Easy Integration
- Compact 55 x 40 x 35 mm Form Factor
- Sony [AITRIOS](#) Software is Required for Use

## Technical Information

### Step. 1

Pass cable through back case bracket

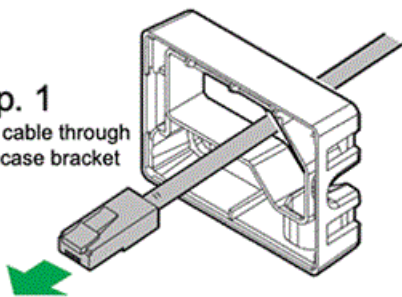

### Important!

Use only "bootless" cable

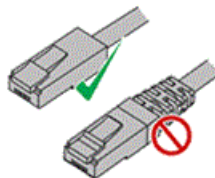

Make sure LEDs are at the bottom

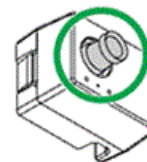
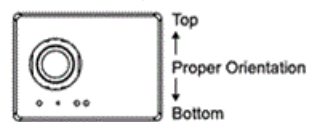

During installation and placement of the camera, do not hit or cause physical stress on the lens as this might affect optical performance.

### Step. 2

Adjust the cable orientation to fit into the one of the case's grooves or straight through, depending on your mounting surface.

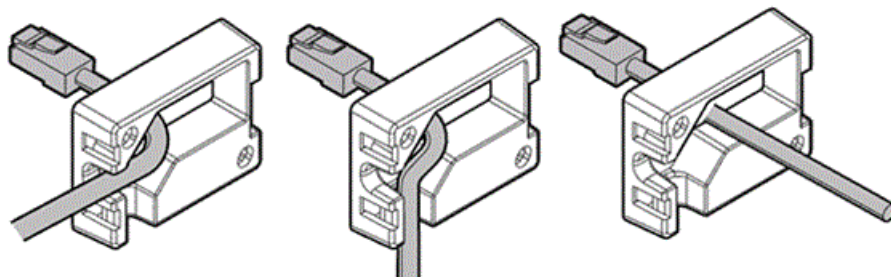

### Step. 3

Mount back case bracket to surface using the screw holes.

Use #8 or similar screw, head size up to 8.5mm, mounting screws sold separately.

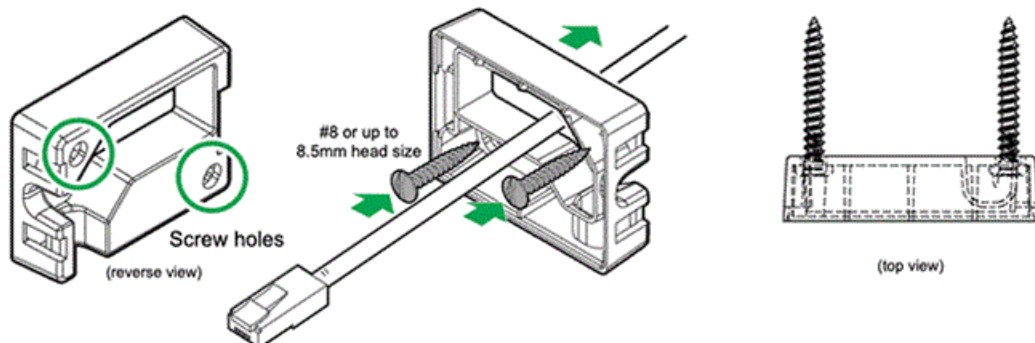

### Step. 4

Connect the cable and camera together.

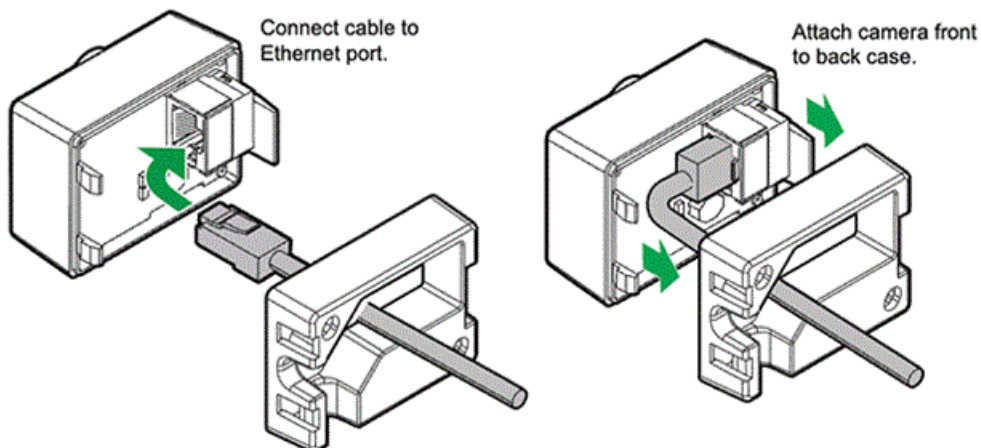

## LUCID Vision Labs™ SENSEiZ Camera Mounting Guide



## LUCID Vision Labs™ SENSEiZ Camera Dimensions

## Products

Title	Stock Number	Price	Buy
LUCID Vision Labs™ SENS AiZ SZP123S-001, Sony IMX500, 12.33MP, Color Camera	<a href="#">#25-114</a>	£334.05	5 In Stock



Copyright 2023 | Edmund Optics, Ltd Unit 1, Opus Avenue, Nether Poppleton, York, YO26 6BL, UK

Phone: 1-800-363-1992 :

[www.edmundoptics.com](http://www.edmundoptics.com)