

[All Products](#) /
 [Optomechanics](#) /
 [Benchtop Optical Mounts](#) /
 [Optical Mirror Mounts](#)

Metric Mirror Mounts



- Two-Axis Tilt Control
- 25mm Square Mounting Surfaces
- Back or Top Screw Options
- Slotted or Threaded Based Options
- Black Anodized Aluminum
- [Posts](#) and [Post Holders](#) Required for Mounting

Common Specifications

General

Type of Optics:	Square or Rectangular
-----------------	-----------------------

Physical & Mechanical Properties

Construction:	Black Anodized Aluminum, Stainless Steel
---------------	--

Threading & Mounting

Size of Compatible Optics (mm):	3.0 - 25.4
---------------------------------	------------

Technical Information

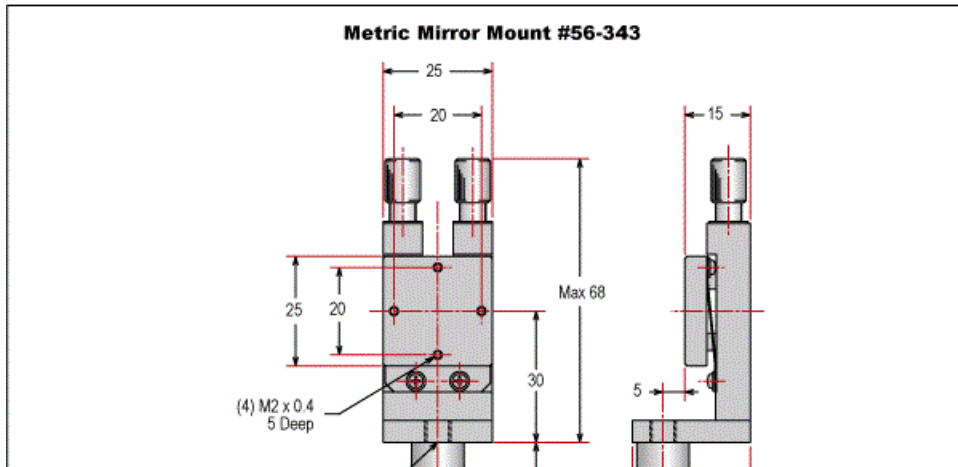
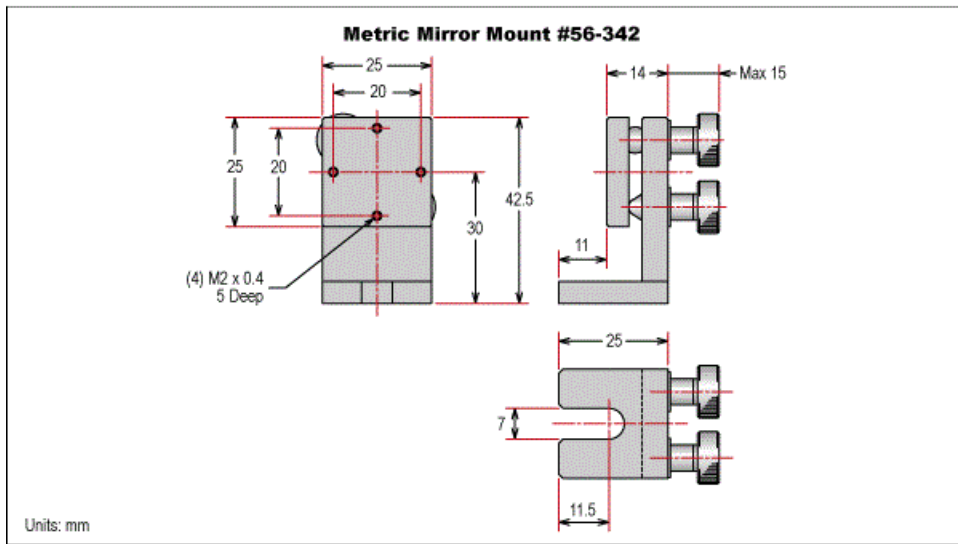
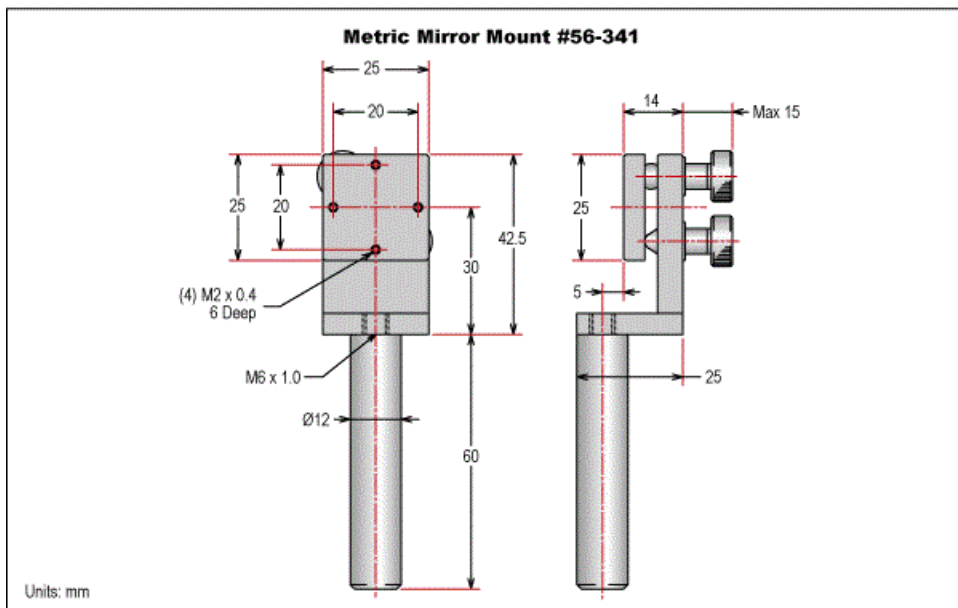

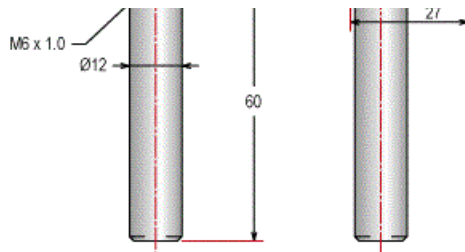

Units: mm

Metric Mirror Mount #56-344

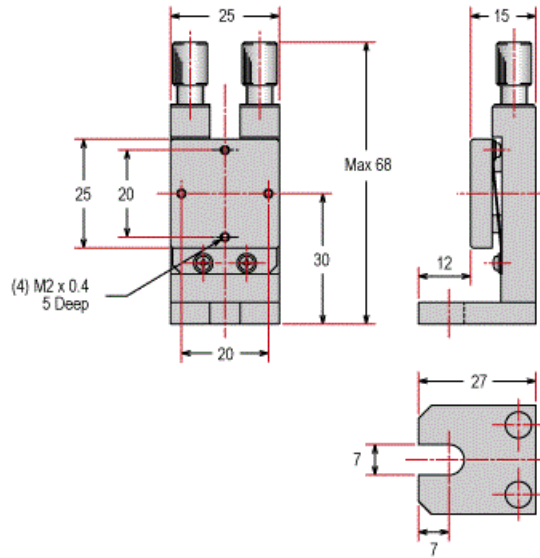

Units: mm

Products

Title	Stock Number	Price	Buy
Standard Model, Slotted Base - Metric Mirror Mount	#56-342	£114.69 Volume Pricing	20+ In Stock
Standard Model, Threaded Base - Metric Mirror Mount	#56-341	£114.69 Volume Pricing	20+ In Stock
Top-Screw Model, Slotted Base - Metric Mirror Mount	#56-344	£152.34 Volume Pricing	20+ In Stock
Top-Screw Model, Threaded Base - Metric Mirror Mount	#56-343	£152.34 Volume Pricing	17 In Stock



Copyright 2023 | Edmund Optics, Ltd Unit 1, Opus Avenue, Nether Poppleton, York, YO26 6BL, UK

Phone: 1-800-363-1992 :

www.edmundoptics.com