

- NOTES:
- 1. SUBSTRATE MATERIAL:
GERMANIUM
 - 2. SURFACE S2 TO BE PARALLEL TO SURFACE S1 WITHIN 1 ARCMIN
 - 3. COATING(APPLY ACROSS CLEAR APERTURE)
S1 & S2: Ravg <5.0% @ 3 - 12µm
 - 4. FINE GRIND SURFACE
 - 5. PROTECTIVE BEVEL AS NEEDED

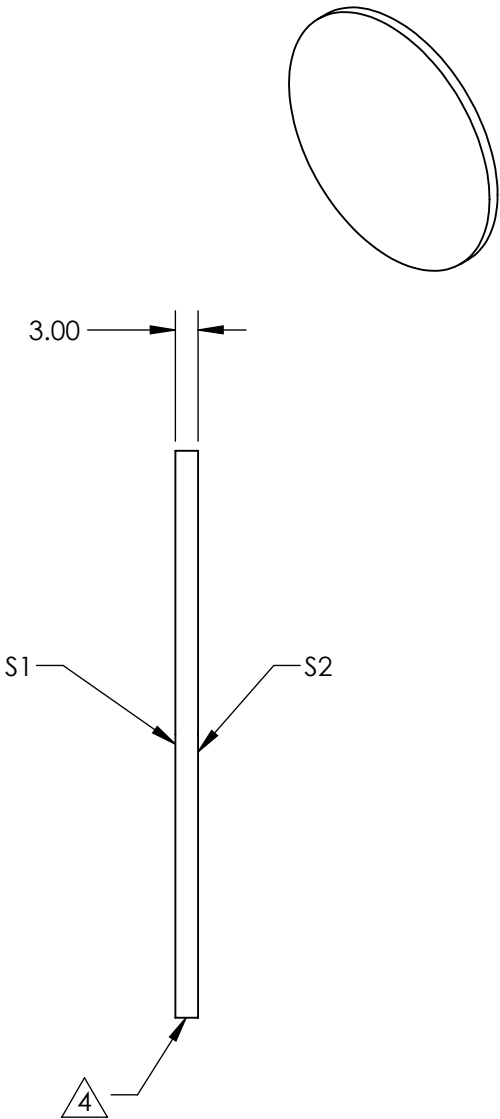
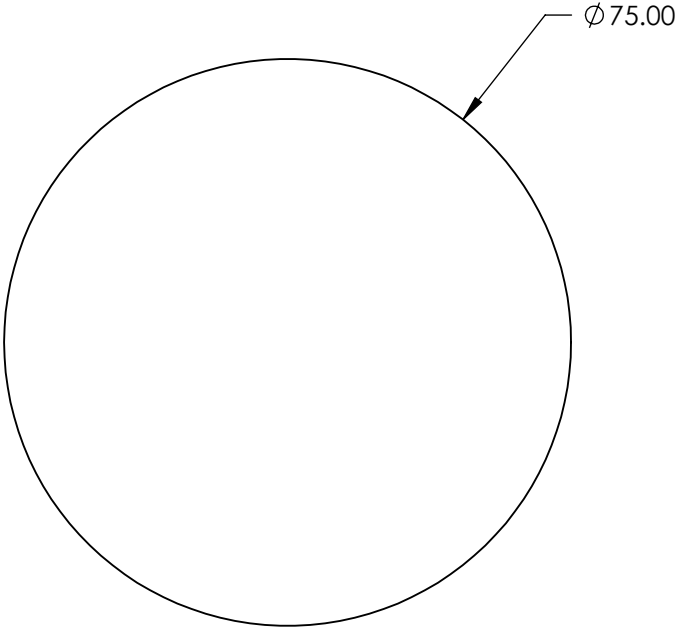

FOR INFORMATION ONLY:
DO NOT MANUFACTURE
PARTS TO THIS DRAWING

SPECIFICATIONS SUBJECT TO CHANGE WITHOUT NOTICE
DIMENSIONS ARE FOR REFERENCE ONLY

	S1	S2
SHAPE	PLANO	PLANO
SURFACE ACCURACY AT 10.6µm (P-V)	λ/10	λ/10
SURFACE QUALITY	60-40	60-40
CLEAR APERTURE	Ø 67.50	Ø 67.50

THIRD ANGLE
PROJECTION

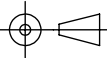

ALL DIMS IN

mm



Edmund Optics®

TITLE

75mm Dia. x 3.0mm Thick 3-12µm AR
Coated, Ge Window

DWG NO

23153

SHEET
8 OF 12