

NOTES:

1. SUBSTRATE MATERIAL:  
FUSED SILICA
2. COATING (APPLY ACROSS CLEAR APERTURE)  
  
S1 & S2: DIELECTRIC  
TRANSMISSION (%): ≥94 (wavelength dependent)  
DAMAGE THRESHOLD, PULSED:  
63.4 J/cm2 @1064nm, 10ns  
2.2 J/cm2 @1030nm, 212fs

4. DESIGN WAVELENGTH: 800nm
5. RoHS COMPLIANT

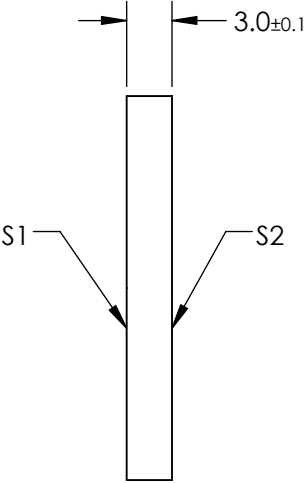
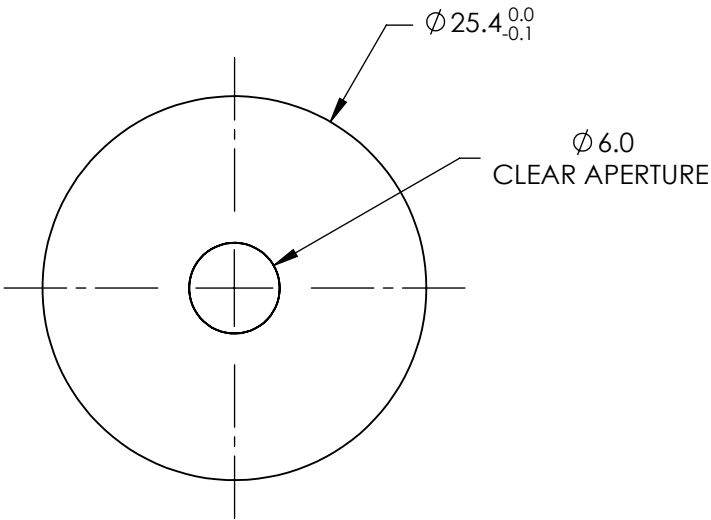

**FOR INFORMATION ONLY:  
DO NOT MANUFACTURE  
PARTS TO THIS DRAWING**

SPECIFICATIONS SUBJECT TO CHANGE WITHOUT NOTICE  
DIMENSIONS ARE FOR REFERENCE ONLY

	S1	S2	<div><div><div>EO<sup>®</sup></div><div>Edmund Optics<sup>®</sup></div></div></div>			
SHAPE	PLANO	PLANO	<div>THIRD ANGLE PROJECTION</div>	TITLE	800nm Higher Order Radial Polarization Converter (S-waveplate)	
SURFACE QUALITY	20-10	20-10		DWG NO	16794	SHEET 1 OF 1
SURFACE FLATNESS	$\lambda/8$	$\lambda/8$				
BEVEL	PROTECTED AS NEEDED	PROTECTED AS NEEDED		ALL DIMS IN	mm	