

NOTES:

1. MATERIAL: STAINLESS STEEL AND BLACK ANODIZED ALUMINUM
2. MAX TRAVEL DISTANCE: 13mm
3. RoHS: EXEMPT

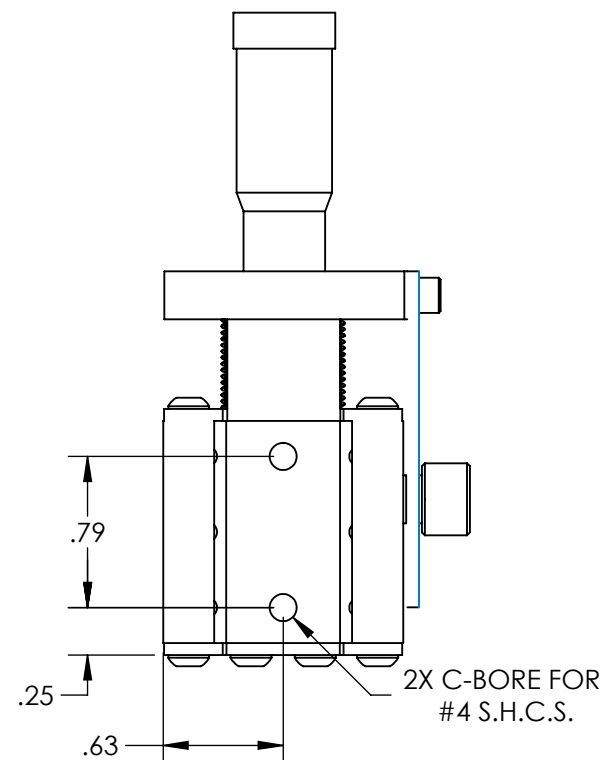
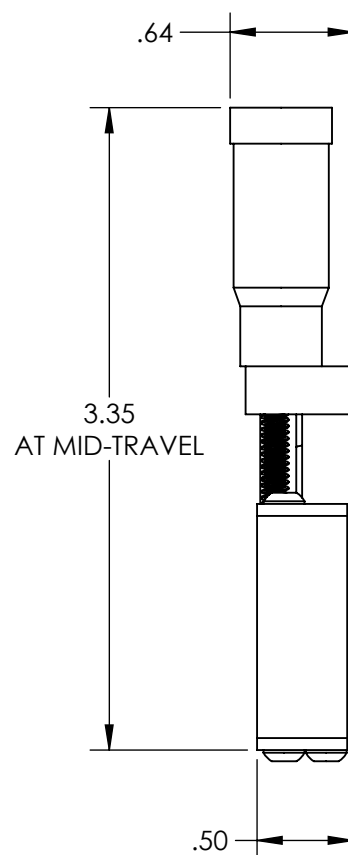
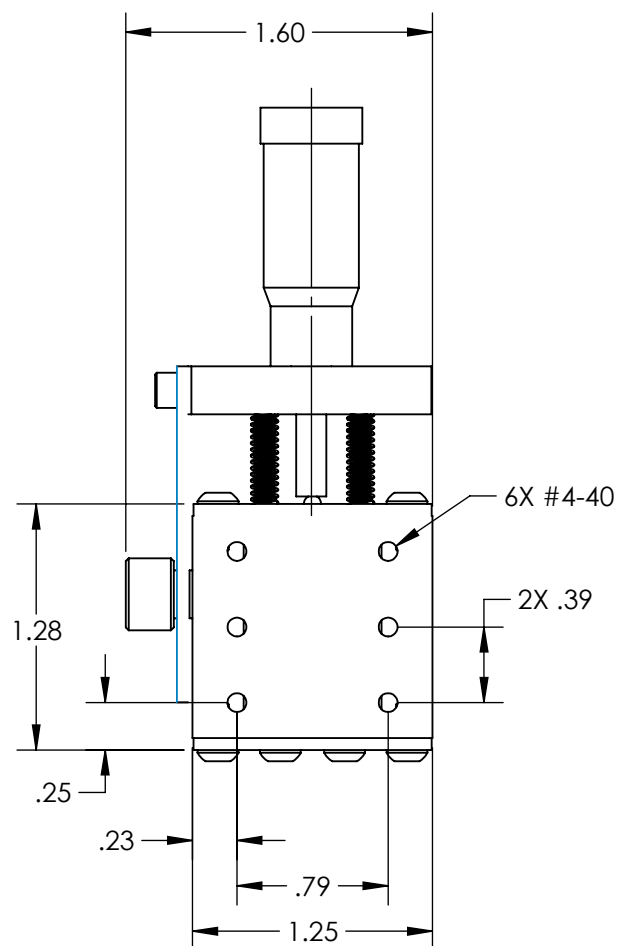

**FOR INFORMATION ONLY:
DO NOT MANUFACTURE
PARTS TO THIS DRAWING**

SPECIFICATIONS SUBJECT TO
CHANGE WITHOUT NOTICE
DIMENSIONS ARE FOR
REFERENCE ONLY

EO® Edmund Optics®

| | | | | | |
|------------------------|----|--------|-------|---|--|
| THIRD ANGLE PROJECTION | | TITLE | | 13mm TRAVEL, METRIC MICROMETER, SOLID-TOPBALL BEARING STAGE | |
| ALL DIMS IN | in | DWG NO | 56357 | SHEET 1 OF 1 | |