

NOTES:

1. SUBSTRATE MATERIAL:
N-BK7

2. COATING (APPLY ACROSS CLEAR APERTURE)

S1 & S2: NIR I (600-1050nm)
R(AVG) ≤0.5% @ 600 - 1050nm

3. FINE GROUND SURFACE

4. RoHS COMPLIANT

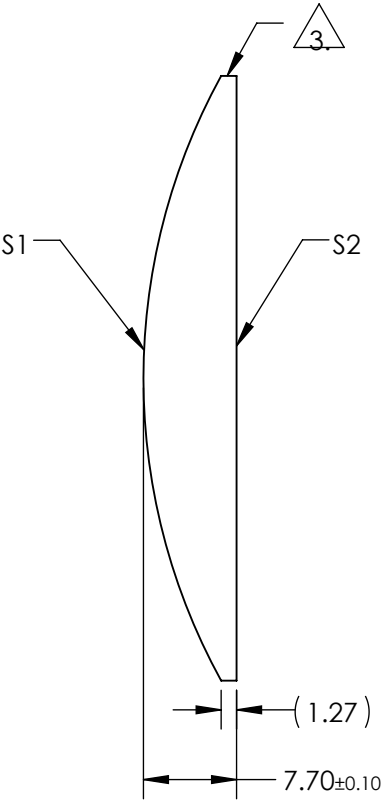
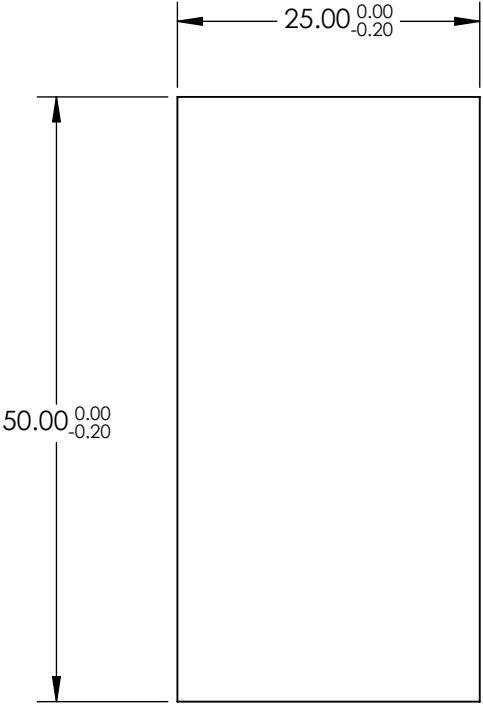

**FOR INFORMATION ONLY:
DO NOT MANUFACTURE
PARTS TO THIS DRAWING**

SPECIFICATIONS SUBJECT TO CHANGE WITHOUT NOTICE
DIMENSIONS ARE FOR REFERENCE ONLY

	S1	S2	EFL	100.00	 Edmund Optics®		
SHAPE	CONVEX	PLANO	BFL	94.93			
RADIUS	51.85	INFINITY			TITLE	50mm H X 25mm L X 100mm FL NIR I COATED, CYLINDER LENS	
SURFACE QUALITY	60-40	60-40					
CLEAR APERTURE	49.00 x 24.00	49.00 x 24.00	ALL DIMS IN		DWG NO	69763	
BEVEL	PROTECTIVE AS NEEDED	PROTECTIVE AS NEEDED					
			mm				SHEET 1 OF 1