

NOTES:

- 1. SUBSTRATE:
N-BK7
- 2. S2 TO BE PARALLEL WITH S1 TO <1 arcmin
- 3. COATING (APPLY ACROSS CLEAR APERTURE)
S1 & S2: RABS <0.25% @ 1550nm

4. FINE GRIND SURFACE

5. RoHS COMPLIANT

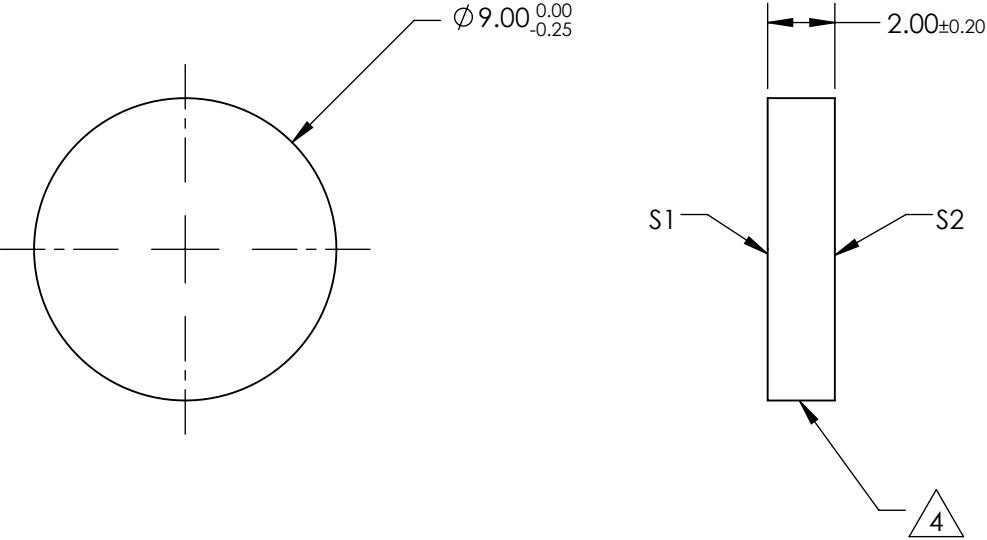
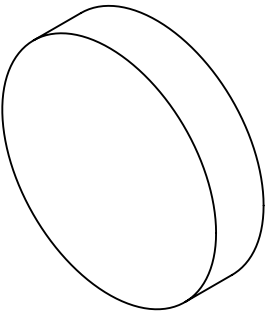

**FOR INFORMATION ONLY:
DO NOT MANUFACTURE
PARTS TO THIS DRAWING**

SPECIFICATIONS SUBJECT TO CHANGE WITHOUT NOTICE
DIMENSIONS ARE FOR REFERENCE ONLY

Edmund Optics®

	S1	S2	THIRD ANGLE PROJECTION		TITLE	9mm DIAMETER, 1550nm V-COAT, λ/4 N-BK7 WINDOW	
SHAPE	PLANO	PLANO					
SURFACE QUALITY	60-40	60-40	ALL DIMS IN		DWG NO	83526	
BEVEL	PROTECTIVE AS NEEDED	PROTECTIVE AS NEEDED				SHEET 1 OF 1	