

NOTES:

1. SUBSTRATE MATERIAL:
BOROFLOAT®
2. COATING (APPLY ACROSS CLEAR APERTURE)

S1: NONE
S2: NONE
3. POWER, IRREGULARITY, SURFACE QUALITY, AND COATING
SPECIFICATIONS APPLY ACROSS CLEAR APERTURE
4.

FINE GROUND SURFACE
5. ROHS COMPLIANT

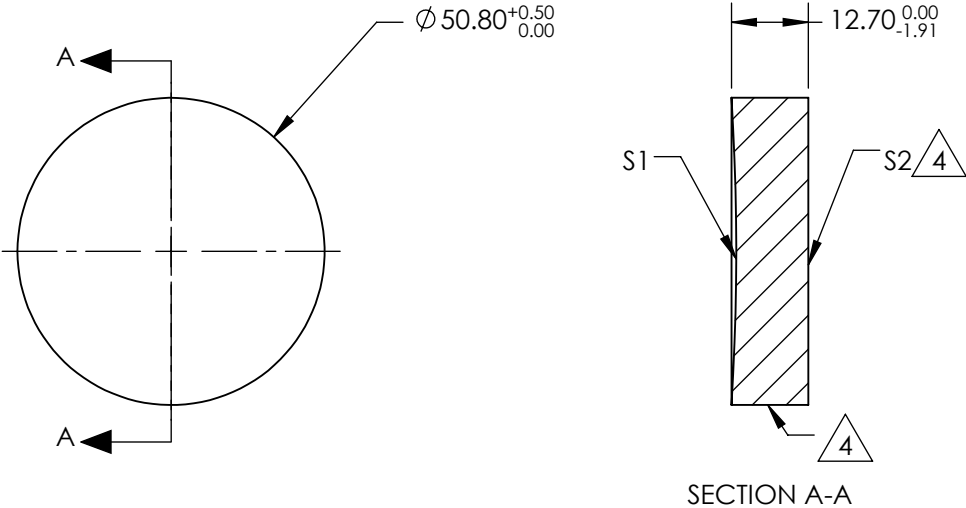

**FOR INFORMATION ONLY:
DO NOT MANUFACTURE
PARTS TO THIS DRAWING**

SPECIFICATIONS SUBJECT TO CHANGE WITHOUT NOTICE
DIMENSIONS ARE FOR REFERENCE ONLY

REV. A	S1	S2	<div><div></div><div>Edmund Optics®</div></div>				
SHAPE	CONCAVE	PLANO					
EFFECTIVE FOCAL LENGTH	203.2mm	N/A					
FOCAL LENGTH TOLERANCE	±2%	N/A					
APERTURE	f/4	N/A					
SURFACE QUALITY	60-40	60-40	<div>THIRD ANGLE PROJECTION</div> <div></div>	TITLE	2" Dia, 8" FL UV Enhanced Alum., Spherical Mirror		
SURFACE FLATNESS	λ/4	λ/4		ALL DIMS IN	mm	DWG NO	49608
BEVEL	PROTECTIVE AS NEEDED	PROTECTIVE AS NEEDED					

 Edmund Optics®