

NOTES:

- 1. SUBSTRATE:
N-BK7
- 2. INCIDENT AND REFLECTED BEAMS SHALL BE PARALLEL TO WITHIN 3 ARCSEC
- 3. COATING (APPLY ACROSS COATING APERTURE)
S1: NONE

S2: NONE
- 4. FINE GRIND SURFACE
- 5. ROHS: COMPLIANT

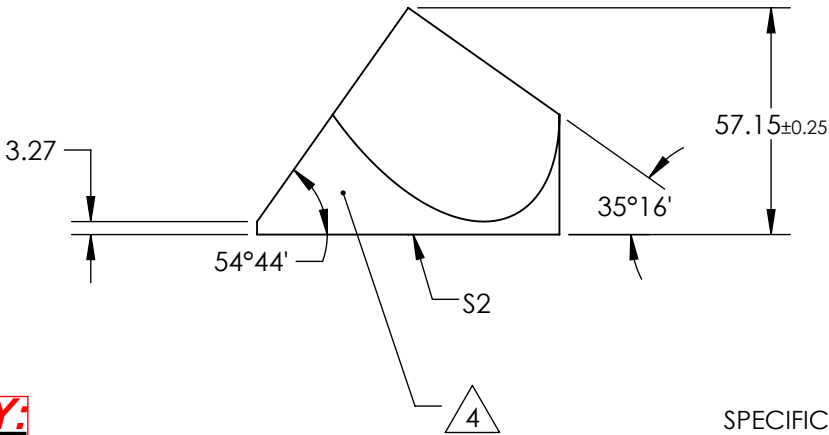
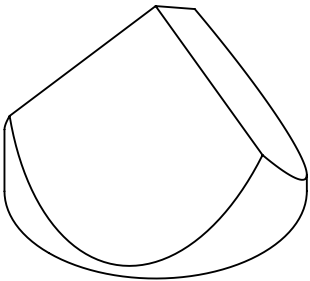
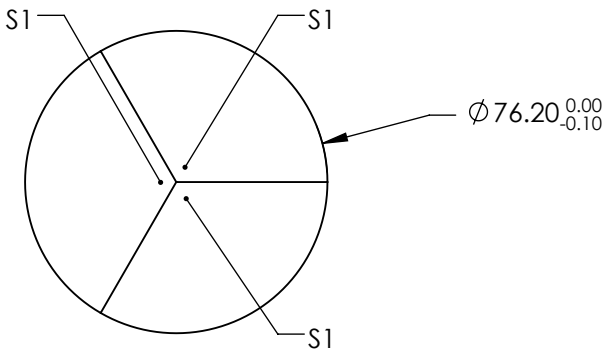

**FOR INFORMATION ONLY:
DO NOT MANUFACTURE
PARTS TO THIS DRAWING**

SPECIFICATIONS SUBJECT TO CHANGE WITHOUT NOTICE
DIMENSIONS ARE FOR REFERENCE ONLY

| | | | | |
|------------------|---------------------|------------------------|--------|--------------------------|
| REV A | S1 & S2 | Edmund Optics® | | |
| SURFACE FLATNESS | $\lambda/8$ | THIRD ANGLE PROJECTION | TITLE | 76.2mm CORNER CUBE PRISM |
| SURFACE QUALITY | 60-40 | | DWG NO | 43301 |
| WAVELENGTH RANGE | 400 - 2200 nm | ALL DIMS IN | mm | SHEET 1 OF 1 |
| BEVEL | PROTECTED AS NEEDED | | | |