

**FOR INFORMATION ONLY:  
DO NOT MANUFACTURE  
PARTS TO THIS DRAWING**

NOTES:

1. SUBSTRATE: UV FUSED SILICA
2. SURFACE S2 TO BE PARALLEL WITH SURFACE S1 TO WITHIN 5 arcsec
3. COATING (APPLY ACROSS COATING APERTURE)

S1: HARD DIELECTRIC SPUTTERED  
T(avg):  $\geq 91\%$  FROM 865 - 1650nm @ 0° AOI  
T(avg):  $\leq 0.01\%$  FROM 200 - 835nm @ 0° AOI  
T(abs):  $\approx 50\%$  FOR 850 $\pm$ 8.5nm @ 0° AOI

S2: SINGLE LAYER MgF<sub>2</sub>

4. FINE GRIND SURFACE

5. POWER, IRREGULARITY, AND SURFACE QUALITY SPECIFICATIONS  
APPLY ACROSS CLEAR APERTURE
6. TRANSMITTED WAVEFRONT DISTORTION, RMS:  $\leq \lambda/4$  @ 633nm (prior to coating)
7. ROHS COMPLIANT

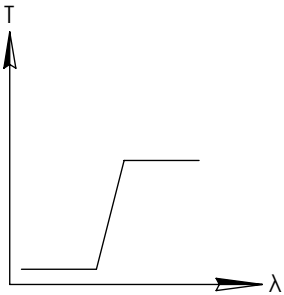
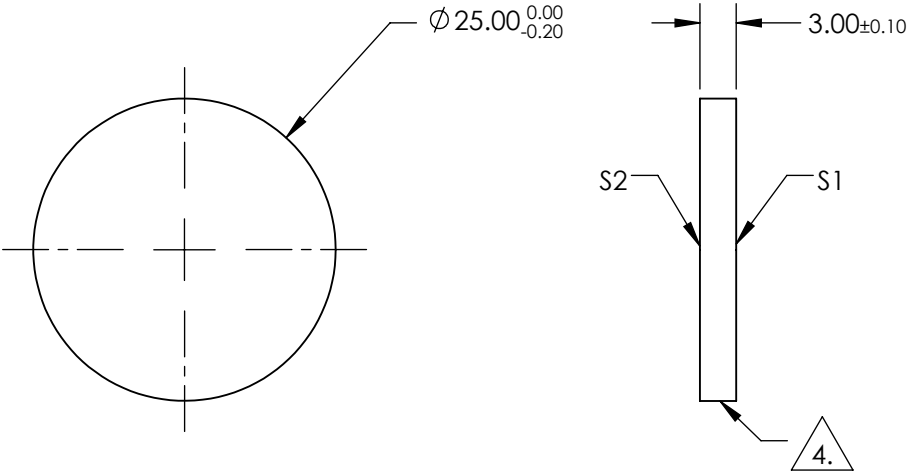
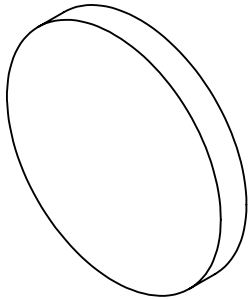

LONGPASS FILTER

SPECIFICATIONS SUBJECT TO CHANGE WITHOUT NOTICE  
DIMENSIONS ARE FOR REFERENCE ONLY

|                 | S1                   | S2                   |
|-----------------|----------------------|----------------------|
| SHAPE           | PLANO                | PLANO                |
| SURFACE QUALITY | 60-40                | 60-40                |
| CLEAR APERTURE  | >80%                 | >80%                 |
| BEVEL           | PROTECTIVE AS NEEDED | PROTECTIVE AS NEEDED |

|                           |    |
|---------------------------|----|
| THIRD ANGLE<br>PROJECTION |    |
| ALL DIMS IN               | mm |

|        |   |                 |  |
|--------|---|-----------------|--|
|        |   |                 |  |
| TITLE  | Ø25mm, 850nm, HIGH PERFORMANCE<br>LONGPASS FILTER |                 |  |
| DWG NO | 66236   | SHEET<br>1 OF 1 |  |